



DIXON AUTOMATIC TOOL, INC.

Products for Automated Assembly

Model AP-127 Part Placer



The Model AP-127 Part Placer is ideally suited for automated assembly systems. It is designed to place pieceparts. The Part Placer is fully automatic and equipped with a vibratory bowl feeder system, interlocking controls, hardened inclined steel track, and transfer escapement. The transfer escapement places each piecepart into the placer head's placement jaws. The placement jaws hold the piecepart in position until the piecepart is engaged in the workpiece. The AP-127 provides a pressing force of 38.6 kilograms (85 pounds). A larger cylinder can be installed to increase the pressing force to 79 kilograms (175 pounds) depending on the placement force requirements. The baseplate size is determined by the size of the bowl feeder system.

Feed System Information	
Feed System	Vibratory Feeder Bowl
Bowl Size	228.6-914mm (9-36 in.)
Track	Inline Vibratory Fed Track
Escapement	Air Escapement
Piece Part Information	
Shank Diameter	2.84mm-6.35mm (.112 in. - .250 in.)
Shank Lengths	Max 101.6mm (4.0 in.)
Head Diameters	Max 25.4mm (1.0 in.)
Disc-Shaped Parts	Max 64mm diameter (2.5 in.)

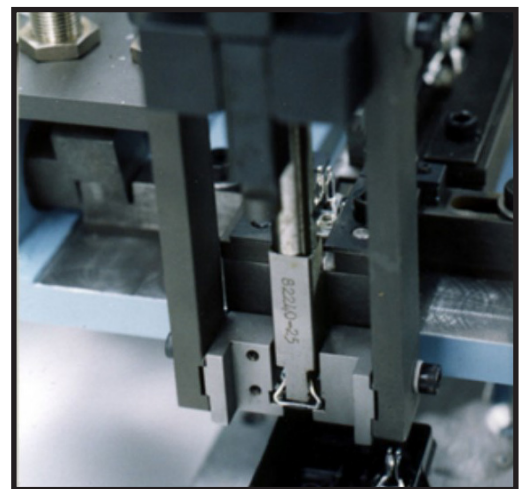

AP-127 Jaws and Tooling

AP-127 Part Placer Head

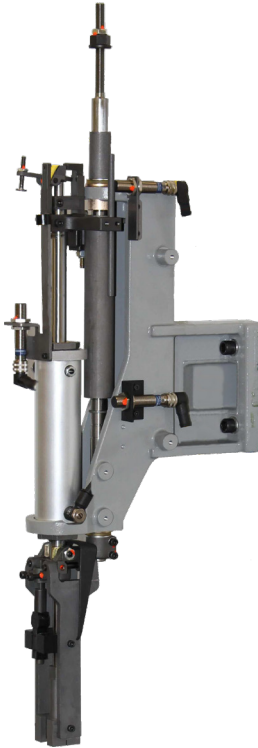

AP-127 Dimensional Data

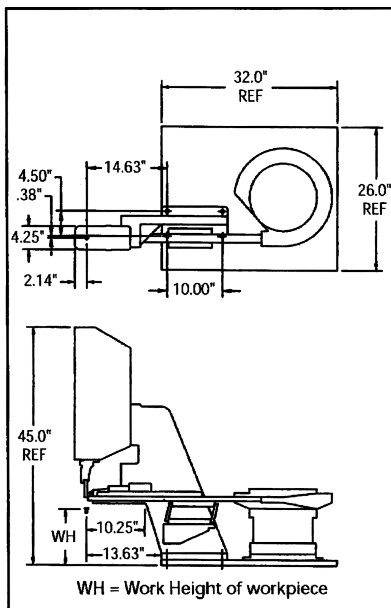

NOTE: We reserve the right to make further technical changes without notice.
CAD drawings are available

Note: Baseplate varies with bowl size:
12-inch ID bowl shown

Standard Head Features	
Head Stroke	50.8mm, 76.2mm 101.6mm, 127mm (2 in., 3 in., 4 in., 5 in.)
Pressing Force	178-778N (40-175 lbs.) Standard Max 378N(85 lbs. Force) 38.1mm (1.5 in.) Cylinder Optional Max 778N (175 lbs. Force) 50.8mm (2.0 in.) Cylinder
Air Supply	6.3 Bar (90 PSI)
Proximity Switches	Std: 24 VDC PNP Others Optional
Valves	Four-way pneumatic valve (24 VDC)
Inline Load Cells Can Be Added	

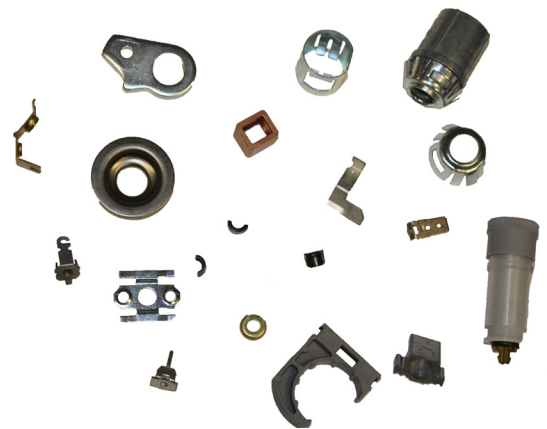

DIXON AUTOMATIC TOOL, INC.
2300 23rd Avenue, Rockford, IL 61104 USA
P: 815-226-3000 | sales@dixonautomatic.com
www.dixonautomatic.com